

Join the project!!

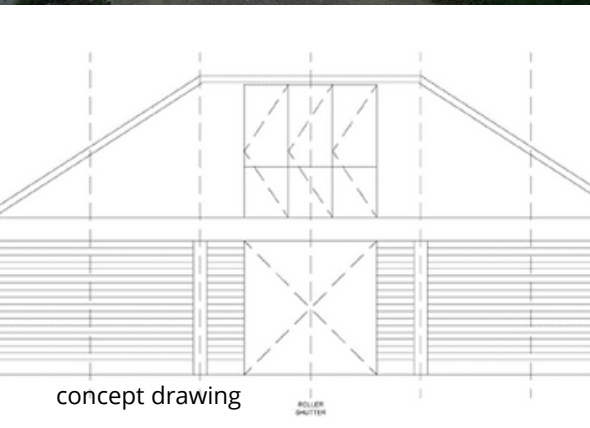

Current hut - HQ since 1922



concept drawing

Why a new hut?

- A unique aspect of our Scout group is that we can teach water safety and activities in addition to other life skills.
- We have a large waiting list with limited capacity to grow further.
- The current hut is 100 years old which means it presents regular maintenance issues and is inefficient environmentally.
- Small changing facilities, toilets and catering areas create limitations.
- Expansion will enable more upskilling and community engagement initiatives extending our positive social impact.

5 Year Plan

- 2026-2027
New Hut Build & Completion
- 2024-2025
Fundraising Campaign
- 2023
Agree design and cost,
Fundraise
- 2022
Build 2 key project teams
 - Planning
 - Fundraising

Bring your talent!

To achieve the goal of planning, designing and raising the funds (circa £750k!!) to build a new hut for our Scout group to benefit from now - and for the next 100 years, we need to pool our skills as a community and come together.

Register your interest [here](#) to let us know how you can help - or scan the QR code.



Contact email : hutplan@waltonviking.uk

